

PCM3-997-Media

NTV-KIT114/283

Adds iPod, AUX, USB-media and Bluetooth to 2009 and Up Porsche 997 vehicles equipped with PCM3 radios

Kit Contents

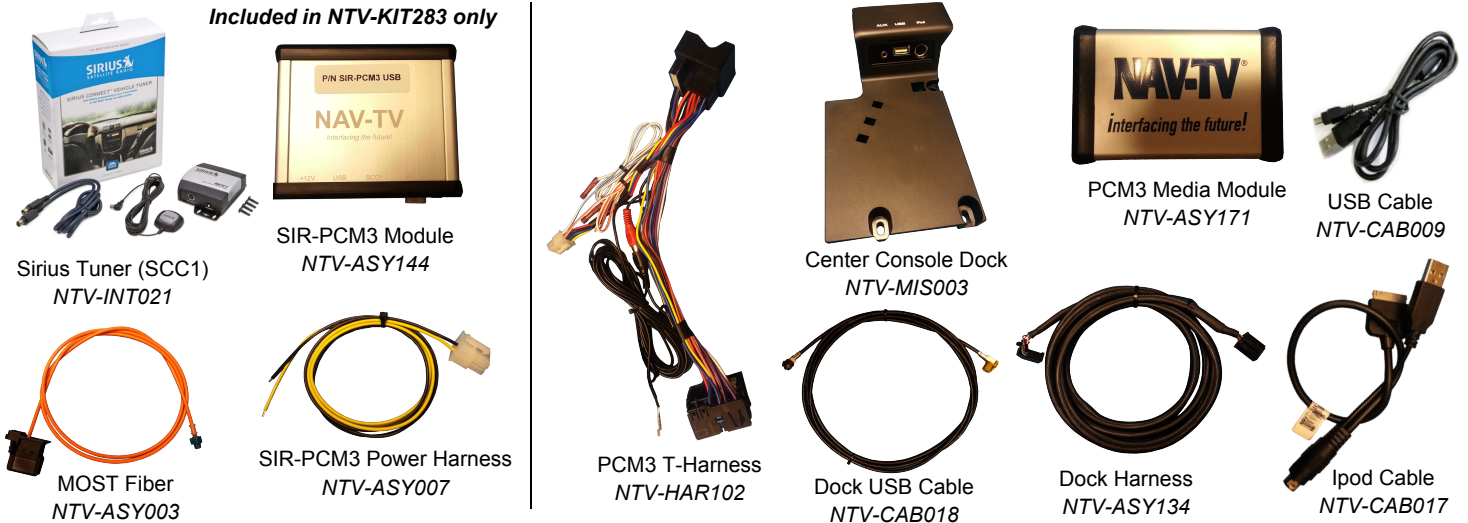

Radio Removal and Installation

1. On either side of the center console there will be a carpeted panel. Unscrew the panel (T27 Torx) and set aside Remove two T20 screws on each side of the vinyl (leather) panels that were exposed by removing the carpeted panel. After the screws have been removed, take the plastic/vinyl cover and pull toward rear of vehicle and remove. (Repeat steps for both passenger and drivers side panels).
2. There will be (4) Allen screws (2 on each side of the radio) on the side of the radio. Turn 1/4 turn counter-clockwise to release the radio.
3. Pull the radio straight toward the back of the vehicle and proceed with the installation.
4. Remove the fiber optic connector from the factory harness by gently prying up on the locking tab with a pick tool. Plug in the supplied T-harness to the factory harness. Plug in the Interface module into the 8-Pin connector on the T-harness. Secure the Interface module in the dash.

Radio Dash Images

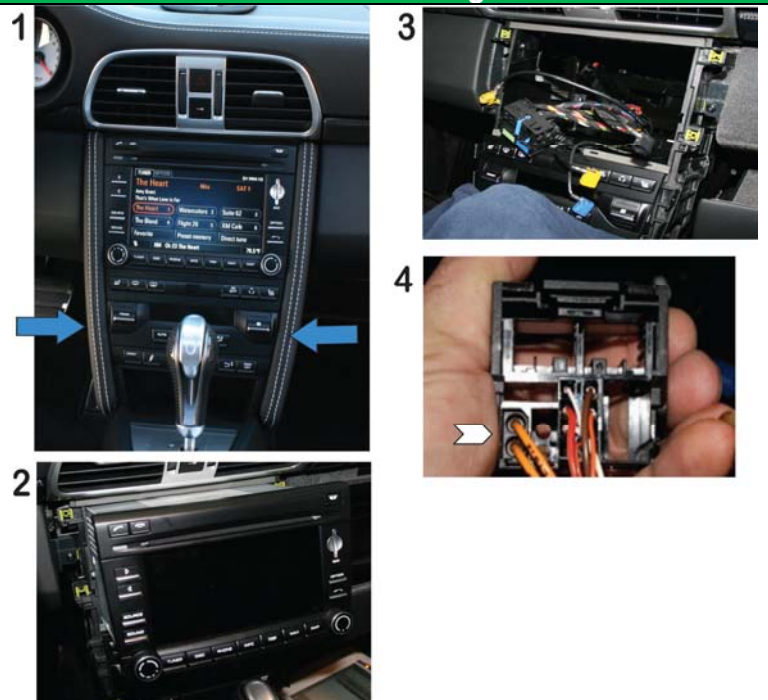

Radio Removal and Installation (Cont.)	Radio Dash Images (Cont.)
----------------------------------------	---------------------------

5. Connect the Media dock USB connector to the USB connector on the back of radio.
6. Connect the Media dock cable into radio side of T-harness.
7. Plug in the fiber connector into the radio side of the T-harness and connect to the radio.
8. Run the Dock harness from the radio inside of the center console, and remove the center factory armrest tray. Connect the dock harness to the media dock and the media dock USB cable to the media dock and secure the new dock tray below the center console armrest.

Note: See Mic install supplement for microphone installation.

Reinstall Dash in reverse order.

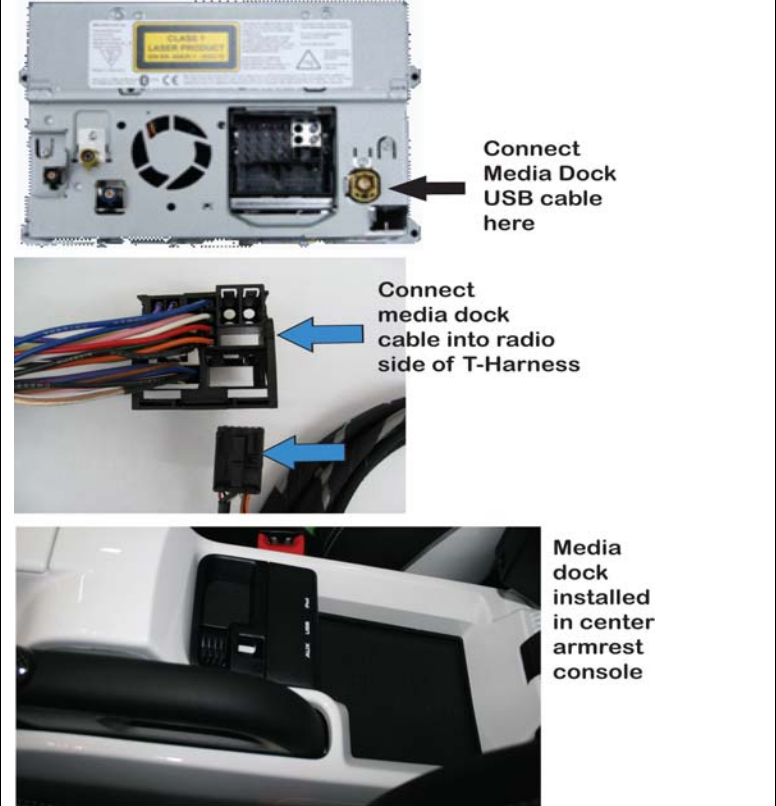

8 Pin Molex wiring guide	8 Pin Molex connector image
--------------------------	-----------------------------

1. CAN High to radio (Yellow wire)
2. CAN Low to radio (Blue wire)
3. Chassis ground (Black wire)
4. +12V output to camera (White/Red wire)
5. CAN High to vehicle (Yellow wire)
6. CAN Low to vehicle (Blue wire)
7. +12V Constant power (Red wire)
8. +12V output for camera switcher (White/Blue)

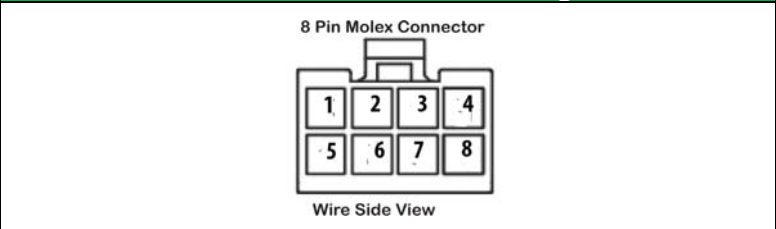

Programming

Programming the interface:

1. **Key On**
2. **Headlights On**
3. **Parking Brake engaged**
4. **Hold Brake pedal down**
5. **Flash High-Beams:**
 4 or 8 times for vehicles with navigation
 10 times for vehicles without navigation

Note1: The PCM must be deprogrammed before the vehicle is taken in for service.

Note2: If the maps get disabled after programming the interface. Repeat programming steps 1-5, substituting flashing the high-beams 8 times instead of 4 in step 5.

Deprogramming the interface:

1. **Key On**
2. **Headlights On**
3. **Parking Brake engaged**
4. **Hold Brake pedal down**
5. **Flash High-Beams 6 times**

Operation

1. iPod, AUX, USB-Media and Bluetooth are enabled with activating the interface module in programming and are accessed through on-screen and radio controls. Note: You cannot use the iPod and the Auxiliary input simultaneously because they share the same audio path.
2. Initial pairing of phone to Radio Bluetooth. Accept request from phone on radio, enter any 4 digit number on radio and press OK, enter same 4 digit number on phone and OK. **Note:** (Write the 4 digit number down and do not lose it. You will need it if the phone or radio loses the pairing connection information).

Agreement: End user agrees to use this product in compliance with all State and Federal laws. NAV-TV Corp. would not be held liable for misuse of its product. If you do not agree, please discontinue use immediately and return product to place of purchase.